

Midland Handling Equipment Ltd

STRETTON ROAD, GREAT GLEN, LEICESTER. LE8 9GN

Telephone 0116-2593175 Fax 0116-2592820

E-mail enquiries@mhel.co.uk



Data Sheet

Trakmaster 406 Free Track Medium/heavy duty

General Specification

The Trakmaster '406' Free track system is a non-powered conveyor. It is a medium/heavy duty overhead conveyor consisting of two 'top hat' track sections with special trolleys designed to suit the shape of the track. These trolleys are manually pushed around the track layout, carrying the particular load the system is designed to transport. Each trolley can carry up to **250kg**, but by linking two trolleys together with a load bar, **500kg** can be transported.

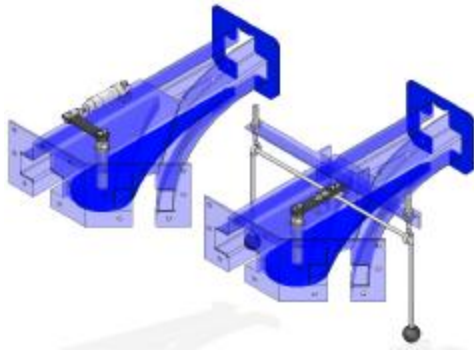

Track Switch

Track switches allow loads to be diverted into multiple lines for storage or to feed workstations. Both left and right hand track switches are available with pneumatic or manual control.

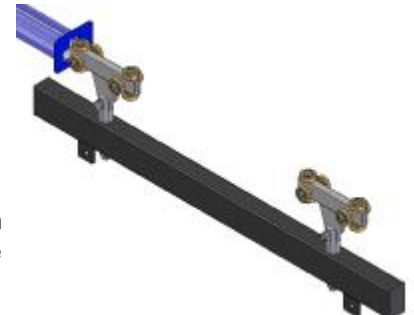
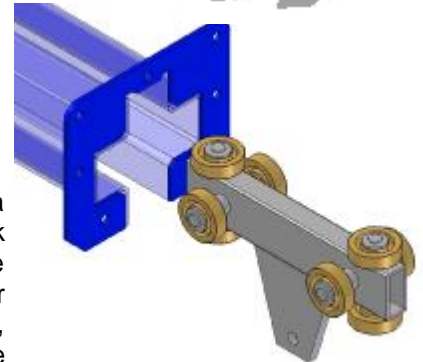

Turntable

Turntables are used to change a trolley or load bars direction. Single turntables are available in different sizes, as well as double turntables with centres to suit the application. Pneumatic cylinders and switches operate the control.

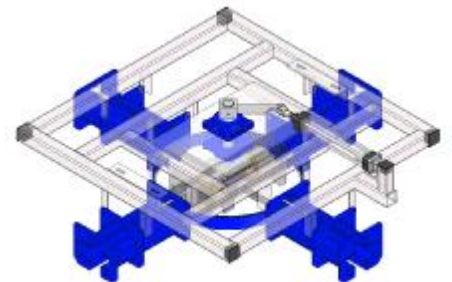

Inspection

This would be incorporated in a readily accessible position in the circuit for inspection and preventative maintenance.

Lift / Lower Units

This unit aids the loading and unloading of products, particularly heavy items, which is an important Health & Safety consideration. They can be pneumatic or chain operated.

Support Structure

The conveyor would be either floor supported using square hollow section forming a rigid structure and incorporating base plates, or roof supported utilising track hanger clamps connected to tubular suspensions. Please see specification for specific proposals.

Trolley Attachments

A wide variety of attachment can be fitted to a trolley or a load bar.

Finish

Track & steelwork finished mid blue paint, machined parts self colour or to customers own requirement.

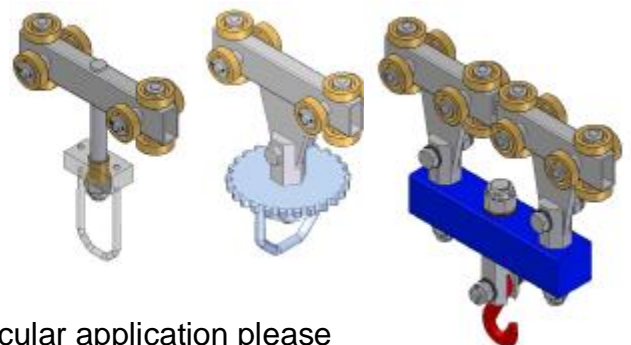

For further help and information or to discuss a particular application please contact us, as above.